

9.3 CHASSIS SECTION

A

B

C

D

E

F

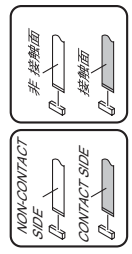
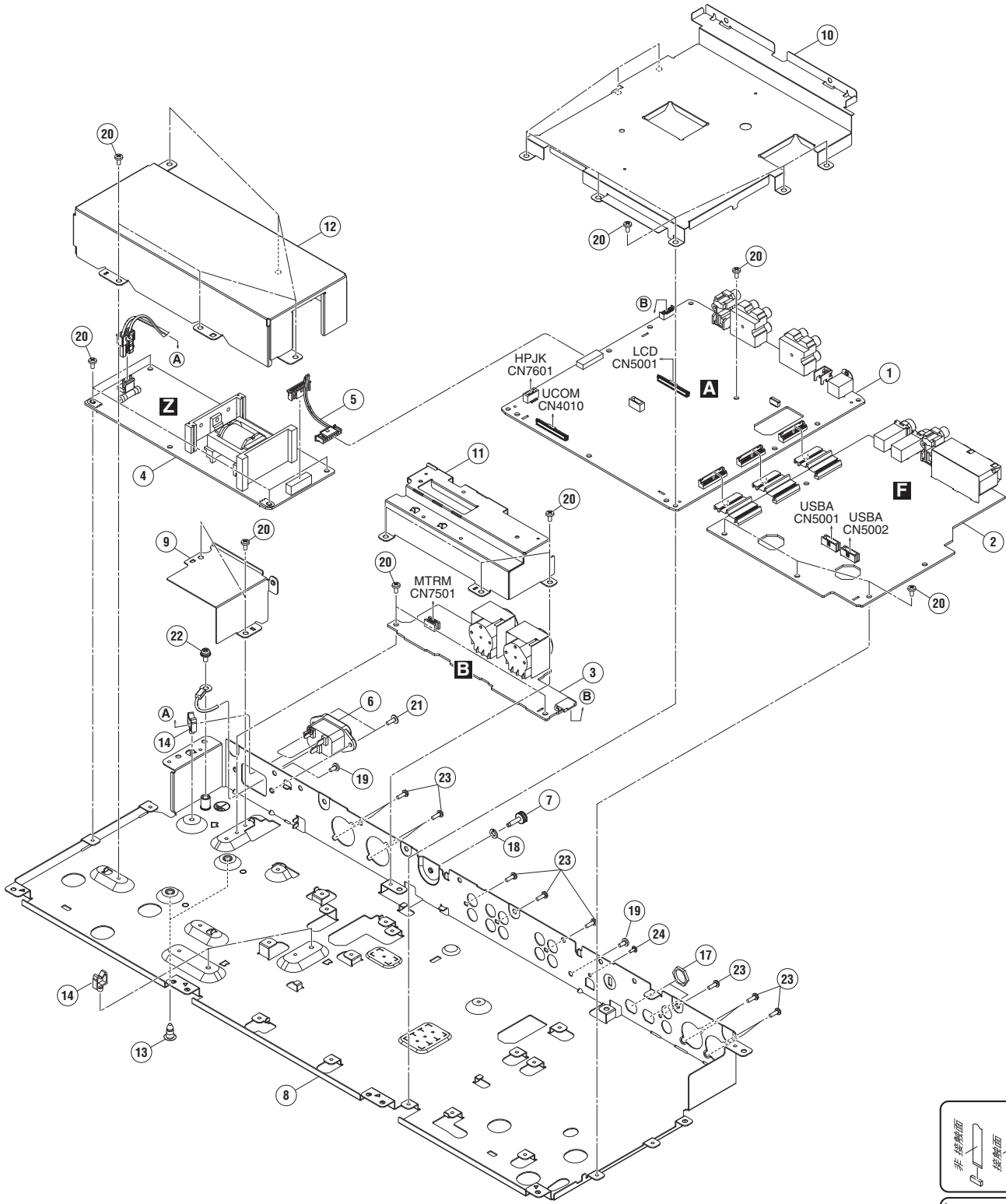

CHASSIS SECTION PARTS LIST

| <u>Mark No.</u> | <u>Description</u> | <u>Part No.</u> | |
|-----------------|--------------------|-----------------|---|
| 1 | MAIN Assy | DWX4035 | |
| 2 | AOUT Assy | DWX4046 | A |
| 3 | MCJK Assy | DWX4047 | |
| ⚠ | 4 SW POWER SUPPLY | DWR1548 | |
| 5 | Crimp Connector | DDC1026 | |
| ⚠ | 6 AC Inlet | DKP3983 | |
| 7 | Earth Terminal | DKE1015 | |
| 8 | Stay | DNH3298 | |
| 9 | Shield Case | DNH3302 | |
| 10 | Shield Case | DNH3304 | |
| 11 | Shield Case | DNH3305 | B |
| 12 | Shield Case | DNH3306 | |
| NSP | 13 PCB Holder | PNW1706 | |
| 14 | Holder | VEC1355 | |
| 15 | ••••• | | |
| 16 | ••••• | | |
| 17 | Nut (M12) | NKX2FNI | |
| 18 | Spring Lock Washer | WS40FNI | |
| 19 | Screw | BBZ30P060FTB | |
| 20 | Screw | BBZ30P060FTC | C |
| 21 | Screw | IBZ30P080FTB | |
| 22 | Screw | PMH40P080FTC | |
| 23 | Screw | PPZ30P080FTB | |
| 24 | Screw (M3*5) | DBA1340 | |